

DermaBlue™  Foam

DermaBlue™  Foam
Transfer



Informational E-book
for healthcare professionals

DermaRite®

WON AND DONE

DermaBlue+ Foam works even where other dressings fail. DermaBlue+ Foam combines triple action antimicrobial protection with a unique micro-pore foam that wicks exudate away from the wound and kills over 99% of bacteria within, helping to disrupt the formation of biofilm and aiding in the healing of even the most challenging chronic wounds.

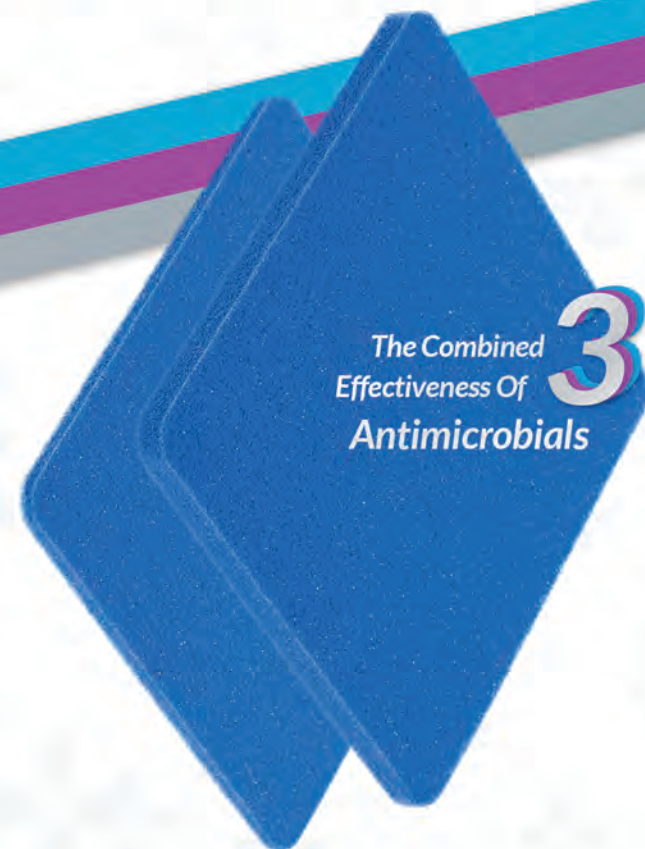

DermaBlue+ Foam

DermaBlue+ Foam Transfer

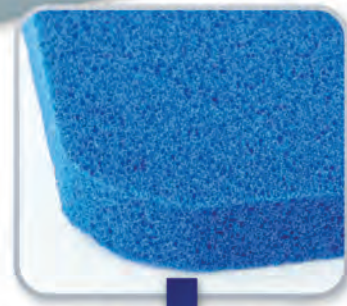

Advanced Capillary Action™ (ACA) Foam
Proprietary micro-pore foam wicks bacteria-laden exudate vertically into the dressing and away from the wound bed.

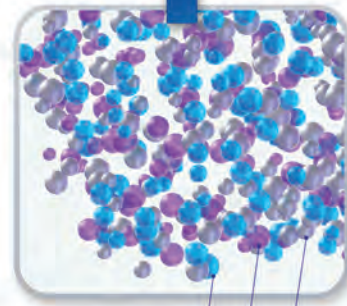

Methylene Blue
Gentian Violet
Silver Zirconium Phosphate

Triple Action Antimicrobial Protection
Three proven antimicrobials - Gentian Violet, Methylene Blue, and Silver Ions - embedded in the fibers of the foam work synergistically to kill over 99% of bacteria in the dressing.

- Three proven antimicrobials work together to provide **sustained, broad spectrum antimicrobial protection for up to 3 days**
- **Helps inhibit the growth of biofilm** by absorbing exudate and killing the microbes within
- **Highly absorbent foam** provides an optimal wound healing environment

DermaRite®

For a sample or to place an order, please contact your DermaRite Sales Representative, call 1-800-337-6296, or email info@dermarite.com

Product	Size	Reorder #	Units
DermaBlue+ Foam	2x2	76020214	10/Box
DermaBlue+ Foam	4x4	76040414	10/Box
DermaBlue+ Foam	4x4	72040414	20/Box
DermaBlue+ Foam	4x5	76040514	10/Box
DermaBlue+ Foam	8x16	75081614	5/Box
DermaBlue+ Foam Transfer	2x2	76020218	10/Box
DermaBlue+ Foam Transfer	4x4	76040418	10/Box
DermaBlue+ Foam Transfer	4x5	76040518	10/Box

DermaBlue+ Foam

DermaBlue+ Foam Transfer

Advanced Capillary Action™ (ACA) Foam

- Proprietary micro-pore foam wicks exudate vertically into the dressing and away from the wound bed.
- Highly absorbent, flexible, light weight, comfortable and resilient.
- Patented process embeds the antimicrobials into the foam itself - ingredients won't wash away, no unwanted skin discoloration, and no interference in the foam's absorbency.
- Ready to use and easy to apply - either side can be applied to the wound and no need to hydrate before use.
- Can be cut to fit, layered, and used for wounds with tunneling or undermining.
- Promotes optimal wound bed temperature.

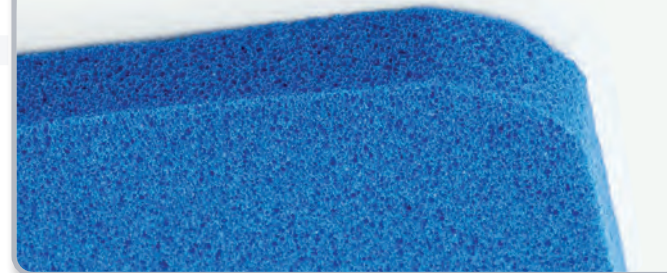

CASE STUDY⁴: 71 y/o female • 15 month old wound • History of systemic immunosuppressant therapy • Previous treatment included: multiple oral antibiotics, systemic antibiotics, debridement, and 6 weeks of Silvaklenz™/Silvion™, Enluxtra™, Drawtex®, and Cutimed®



DermaBlue+ Foam is a highly absorbent vertically-wicking foam primary dressing embedded with three proven antimicrobials. DermaBlue+ Foam provides sustained exudate management and broad spectrum antimicrobial protection for up to 3 days. Use on moderate to heavily exuding partial to full thickness wounds, including pressure and leg ulcers, diabetic foot ulcers, graft wounds, donor sites and surgical wounds.

Combined Triple Action Antimicrobial Protection Provides Broad Spectrum Effectiveness For Up To 3 Days

Studies have shown that the antimicrobial ingredients in DermaBlue+ Foam work in synergy to be up to 3 times more effective than any of the ingredients alone.¹

Methylene Blue (up to 0.25 mg/g)

- Historically proven antimicrobial effectiveness.²
- Effective against a wide range of bacteria and fungi.

Gentian Violet (up to 0.25 mg/g)

- Antibacterial and antifungal properties.
- Effective against gram positive and gram negative bacteria.

Silver Zirconium Phosphate (up to 7 mg/g)

- Noncytotoxic broad spectrum antimicrobial activity.³
- Silver ions (Ag+) are activated in the dressing in an amount proportionate to the level of exudate.
- Compatible with common debriding agents.

A wound treatment attempt that fails costs a facility **\$170-\$681** (avg.) in materials and labor alone.⁵

Managing a wound early with a highly effective wound care treatment like DermaBlue+ Foam can improve patient health and wellbeing, and help facilities reduce cost and labor significantly.



1. Li, R., Chen, J., Cesario, T. C., Wang, X., Yuan, J. S., & Rentzepis, P. M. (2016). Synergistic reaction of silver nitrate, silver nanoparticles, and methylene blue against bacteria. Proceedings of the National Academy of Sciences, 113(48), 13612–13617. <https://doi.org/10.1073/pnas.1611931113> 2. Edwards K. (2016). New Twist on an Old Favorite: Gentian Violet and Methylene Blue Antibacterial Foams. Advances in wound care, 5(1), 11-18. 3. Data on file. DermaRite Industries, LLC, 2019. 4. Marcus, B., MD, FACEP, CWS, & Kaufman, K., LPN, CHT, Wound Care Nurse. (2015, April). Treatment of a complex diabetic foot wound with DermaBlue+ Foam™ wound dressing: A unique absorbent antimicrobial polyurethane foam dressing. Case Study, 5. Estimate based on publicly available data.



DermaBlue™ + Foam

ANTIMICROBIAL FOAM WOUND DRESSING WITH METHYLENE BLUE, GENTIAN VIOLET, AND SILVER

APÓSITO ANTIMICROBIANO DE ESPUMA PARA HERIDAS CON AZUL DE METILENO, VIOLETA DE GENCIANA Y PLATA

For the management of exuding wounds
Para el tratamiento de heridas exudativas

DESCRIPTION

DermaBlue+ Foam Wound Dressing is made of polyurethane/polyether foam, Methylene Blue (up to 0.25 mg/g), Gentian Violet (up to 0.25 mg/g), and Silver Sodium Zirconium Phosphate (up to 7 mg/g). The 3 ingredients provide broad spectrum antimicrobial protection within the dressing.

INDICATIONS FOR USE

DermaBlue+ Foam is indicated for moderately to heavily exuding, partial to full thickness wounds, including: pressure ulcers, leg ulcers, diabetic foot ulcers, graft wounds and donor sites, skin tears, first and second degree burns, surgical wounds, lacerations and abrasions.

CONTRAINDICATIONS

DermaBlue+ Foam should not be used on patients with a known sensitivity to silver or any other contents of the dressing. Not indicated for third-degree burns.

DIRECTIONS (Use under the guidance of a qualified healthcare professional.)

PREPARE WOUND SITE AND SURROUNDING SKIN:

1. Cleanse wound to remove residue according to local infection control protocol.
2. Skin around wound should be clean and dry, use skin barrier prep as needed.

TO APPLY:

1. Remove dressing from package.
2. Dressing may be cut to size prior to application. Dressing may be rolled or layered to lightly pack into wound.
3. Apply dressing directly to wound. Direct contact with entire wound bed is necessary for best results.
4. Secure with tape or appropriate cover dressing that manages drainage and maintains a moist wound environment.

CHANGING THE DRESSING:

- Dressing may be left in place for up to 3 days or as directed by a qualified healthcare professional.
- Change the dressing if drainage shows through the back of the cover dressing; or if the edge of the cover dressing becomes loose; or if the condition of the wound or surrounding skin causes concern; or as directed by a qualified healthcare professional.
- Dressing may be moistened to ease removal.
- Carefully remove adhesive secondary dressings by holding the edge of the dressing and slowly pulling it parallel to the skin.
- Dispose of in accordance with local guidance.

WARNINGS

- For single use only.
- If signs of infection are detected, a qualified healthcare professional should be contacted to decide on the next course of action.
- If signs of an allergic reaction are detected, discontinue use of the product and seek advice from a qualified healthcare professional.
- Product is sterile unless the package is opened or damaged. Do not resterilize.

OTHER INFORMATION

- Store in a dry place at room temperature.
- Keep away from sunlight.
- Not made with natural rubber latex.

Caution: Federal (USA) law restricts this device to sale by or on the order of a physician (or properly licensed healthcare practitioner).

DEPTH / STAGE	ABSORBENCY
PARTIAL FULL	
1 2 3 4	HIGH
For Partial and Full thickness wounds / Pressure ulcers stages 2-4	

DermaRite®

Rx Only

Manufactured for DermaRite Industries LLC
North Bergen, NJ 07047 • 800.337.6296
www.dermarite.com

222036 | REV. 2018-10-24

DermaBlue™ + Foam

ANTIMICROBIAL FOAM WOUND DRESSING WITH METHYLENE BLUE, GENTIAN VIOLET, AND SILVER

APÓSITO ANTIMICROBIANO DE ESPUMA PARA HERIDAS CON AZUL DE METILENO, VIOLETA DE GENCIANA Y PLATA

For the management of exuding wounds
Para el tratamiento de heridas exudativas

DESCRIPTION

DermaBlue+ Foam Wound Dressing is made of polyurethane/polyether foam, Methylene Blue (up to 0.25 mg/g), Gentian Violet (up to 0.25 mg/g), and Silver Sodium Zirconium Phosphate (up to 7 mg/g). The 3 ingredients provide broad spectrum antimicrobial protection within the dressing.

INDICATIONS FOR USE

DermaBlue+ Foam is indicated for moderately to heavily exuding, partial to full thickness wounds, including: pressure ulcers, leg ulcers, diabetic foot ulcers, graft wounds and donor sites, skin tears, first and second degree burns, surgical wounds, lacerations and abrasions.

CONTRAINDICATIONS

DermaBlue+ Foam should not be used on patients with a known sensitivity to silver or any other contents of the dressing. Not indicated for third-degree burns.

DIRECTIONS (Use under the guidance of a qualified healthcare professional.)

PREPARE WOUND SITE AND SURROUNDING SKIN:

1. Cleanse wound to remove residue according to local infection control protocol.
2. Skin around wound should be clean and dry, use skin barrier prep as needed.

TO APPLY:

1. Remove dressing from package.
2. Dressing may be cut to size prior to application. Dressing may be rolled or layered to lightly pack into wound.
3. Apply dressing directly to wound. Direct contact with entire wound bed is necessary for best results.
4. Secure with tape or appropriate cover dressing that manages drainage and maintains a moist wound environment.

CHANGING THE DRESSING:

- Dressing may be left in place for up to 3 days or as directed by a qualified healthcare professional.
- Change the dressing if drainage shows through the back of the cover dressing; or if the edge of the cover dressing becomes loose; or if the condition of the wound or surrounding skin causes concern; or as directed by a qualified healthcare professional.
- Dressing may be moistened to ease removal.
- Carefully remove adhesive secondary dressings by holding the edge of the dressing and slowly pulling it parallel to the skin.
- Dispose of in accordance with local guidance.

WARNINGS

- For single use only.
- If signs of infection are detected, a qualified healthcare professional should be contacted to decide on the next course of action.
- If signs of an allergic reaction are detected, discontinue use of the product and seek advice from a qualified healthcare professional.
- Product is sterile unless the package is opened or damaged. Do not resterilize.

OTHER INFORMATION

- Store in a dry place at room temperature.
- Keep away from sunlight.
- Not made with natural rubber latex.

Caution: Federal (USA) law restricts this device to sale by or on the order of a physician (or properly licensed healthcare practitioner).

DEPTH / STAGE	ABSORBENCY
PARTIAL FULL	
1 2 3 4	HIGH
For Partial and Full thickness wounds / Pressure ulcers stages 2-4	

DermaRite®

Rx Only

Manufactured for DermaRite Industries LLC
North Bergen, NJ 07047 • 800.337.6296
www.dermarite.com

222036 | REV. 2018-10-24



DermaBlue[™] + Foam Transfer

ANTIMICROBIAL FOAM WOUND DRESSING WITH METHYLENE BLUE, GENTIAN VIOLET, AND SILVER

APÓSITO ANTIMICROBIANO DE ESPUMA PARA HERIDAS CON AZUL DE METILENO, VIOLETA DE GENCIANA Y PLATA

For the management of exuding wounds
Para el tratamiento de heridas exudativas

DESCRIPTION

DermaBlue+ Foam Transfer is a thin foam wound dressing that is highly hydrophilic. DermaBlue+ Foam Transfer is made of polyurethane/polyether foam, Methylene Blue (up to 0.25 mg/g), Gentian Violet (up to 0.25 mg/g), and Silver Sodium Zirconium Phosphate (up to 7 mg/g). The 3 ingredients provide broad spectrum antimicrobial protection within the dressing.

INDICATIONS FOR USE

DermaBlue+ Foam Transfer is indicated for moderately exuding, partial to full thickness wounds, including: pressure ulcers, leg ulcers, diabetic foot ulcers, graft wounds and donor sites, skin tears, first and second degree burns, surgical wounds, lacerations and abrasions.

CONTRAINDICATIONS

DermaBlue+ Foam Transfer should not be used on patients with a known sensitivity to silver or any other contents of the dressing. Not indicated for third-degree burns.

DIRECTIONS (Use under the guidance of a qualified healthcare professional.)

PREPARE WOUND SITE AND SURROUNDING SKIN:

1. Cleanse wound to remove residue according to local infection control protocol.
2. Skin around wound should be clean and dry, use skin barrier prep as needed.

TO APPLY:

1. Remove dressing from package.
2. Dressing may be cut to size prior to application. Dressing may be rolled or layered to lightly pack into wound.
3. Apply dressing directly to wound. Direct contact with entire wound bed is necessary for best results.
4. Secure with tape or appropriate cover dressing that manages drainage and maintains a moist wound environment.

CHANGING THE DRESSING:

- Dressing may be left in place for up to 3 days or as directed by a qualified healthcare professional.
- Change the dressing if drainage shows through the back of the cover dressing; or if the edge of the cover dressing becomes loose; or if the condition of the wound or surrounding skin causes concern; or as directed by a qualified healthcare professional.
- Dressing may be moistened to ease removal.
- Carefully remove adhesive secondary dressings by holding the edge of the dressing and slowly pulling it parallel to the skin.
- Dispose of in accordance with local guidance.

WARNINGS

- For single use only.
- If signs of infection are detected, a qualified healthcare professional should be contacted to decide on the next course of action.
- If signs of an allergic reaction are detected, discontinue use of the product and seek advice from a qualified healthcare professional.
- Product is sterile unless the package is opened or damaged. Do not resterilize.

OTHER INFORMATION

- Store in a dry place at room temperature.
- Keep away from sunlight.
- Not made with natural rubber latex.

Caution: Federal (USA) law restricts this device to sale by or on the order of a physician (or properly licensed healthcare practitioner).

DEPTH / STAGE	ABSORBENCY
PARTIAL FULL	MEDIUM
1 2 3 4	
For Partial and Full thickness wounds / Pressure ulcers stages 2-4	



Rx Only

Manufactured for DermaRite Industries LLC
North Bergen, NJ 07047 • 800.337.6296
www.dermarite.com

222036 | REV. 2018-10-24

DermaBlue[™] + Foam Transfer

ANTIMICROBIAL FOAM WOUND DRESSING WITH METHYLENE BLUE, GENTIAN VIOLET, AND SILVER

APÓSITO ANTIMICROBIANO DE ESPUMA PARA HERIDAS CON AZUL DE METILENO, VIOLETA DE GENCIANA Y PLATA

For the management of exuding wounds
Para el tratamiento de heridas exudativas

DESCRIPCIÓN

El Apósito de Espuma para Heridas DermaBlue+ está hecho de espuma de poliuretano/poliéster, azul de metileno (hasta 0,25 mg/g), violeta de genciana (hasta 0,25 mg/g) y fosfato de circonio y plata sódica (hasta 7 mg/g). Los 3 ingredientes proporcionan un amplio espectro de protección antimicrobiana dentro del apósito.

INDICACIONES DE USO

La Espuma DermaBlue+ está indicada para heridas de exudación moderada a fuerte, de espesor parcial a total, incluyendo: úlceras por presión, úlceras de pierna, úlceras de pie diabético, heridas de injerto y zona donante, desgarros de piel, quemaduras de primer y segundo grado, heridas quirúrgicas, laceraciones y abrasiones.

CONTRAINDICACIONES

La Espuma DermaBlue+ no debe usarse en pacientes con sensibilidad conocida a la plata o a cualquier otro contenido del apósito. No está indicado para quemaduras de tercer grado.

INDICACIONES (Usar bajo la guía de un profesional de la salud calificado.)

PREPARAR EL LUGAR DE LA HERIDA Y LA PIEL CIRCUNDANTE:

1. Limpia la herida para eliminar los residuos de acuerdo con el protocolo local de control de infecciones.
2. La piel alrededor de la herida debe estar limpia y seca, utilice una preparación de barrera cutánea según sea necesario.

PARA APLICAR:

1. Retire el apósito del paquete.
2. El apósito puede ser cortado a medida antes de la aplicación. El apósito puede enrollarse o colocarse en capas para que quede ligeramente adherido a la herida.
3. Aplique el apósito directamente sobre la herida. El contacto directo con todo el lecho de la herida es necesario para obtener los mejores resultados.

4. Asegúrelo con cinta adhesiva o un apósito protector apropiado que controle el drenaje y mantenga el ambiente húmedo de la herida.

CAMBIANDO EL APÓSITO:

- El apósito puede dejarse en su lugar hasta por 3 días o según las instrucciones de un profesional de la salud calificado.
- Cambie el apósito si el drenaje se ve a través de la parte posterior del apósito protector; o si el borde del apósito protector se afloja; o si la condición de la herida o de la piel circundante causa preocupación; o según lo indique un profesional de la salud calificado.
- El apósito puede humedecerse para facilitar su remoción.
- Retire con cuidado los apósitos secundarios adhesivos sosteniendo el borde del apósito y tirando lentamente de él paralelamente a la piel.

ADVERTENCIAS

- Para un solo uso.
- Si se detectan signos de infección, se debe contactar a un profesional de la salud calificado para decidir sobre la manera de proceder.
- Si se detectan signos de una reacción alérgica, interrumpa el uso del producto y consulte a un profesional de la salud calificado.
- El producto es estéril a menos que el paquete esté abierto o dañado. No vuelva a esterilizar.

OTRA INFORMACIÓN

- Conservar en un lugar seco y a temperatura ambiente.
- Mantener alejado de la luz solar.
- No está hecho con látex de caucho natural.

Precaución: La ley federal (EE.UU.) permite la venta de este dispositivo únicamente a través de un médico (o de un profesional de la salud debidamente autorizado)

PROFUNDIDAD / ETAPA	CAPACIDAD DE ABSORCIÓN
PARTIAL TOTAL	MEDIANA
1 2 3 4	
Para heridas de grosor parcial y total / Úlceras por presión etapas 2-4	



Sólo Rx

Fabricado para DermaRite Industries LLC.
North Bergen, NJ 07047 • 800.337.6296
www.dermarite.com



Cover Dressing Guide

DermaBlue™ + Foam
DermaBlue™ + Foam Transfer

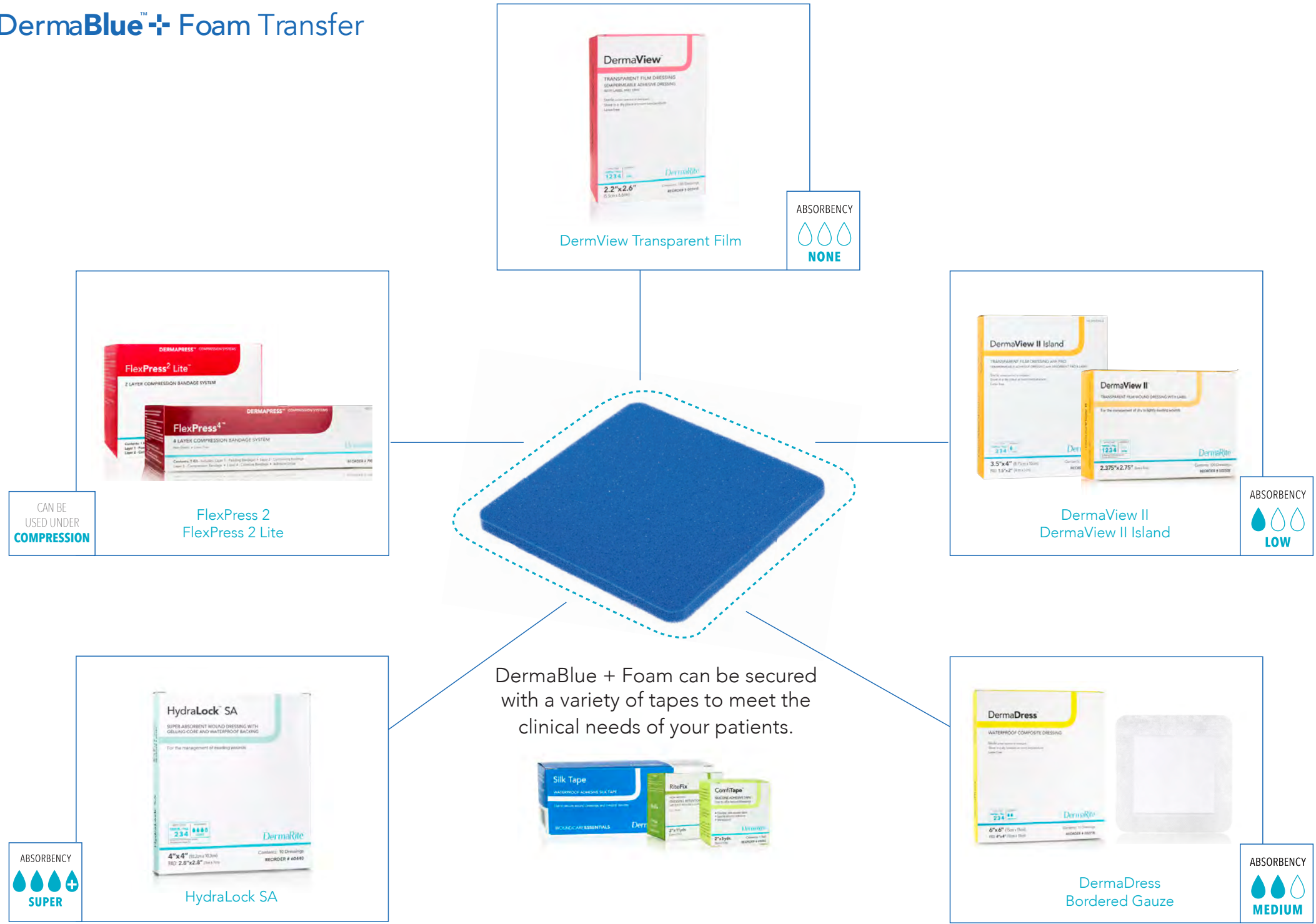

* Ensure tape covers the entire dressing. Tape can be applied to create a backing for DermaBlue + Foam based upon clinical needs.



DermaBlue™ + Foam

DermaBlue™ + Foam
Transfer

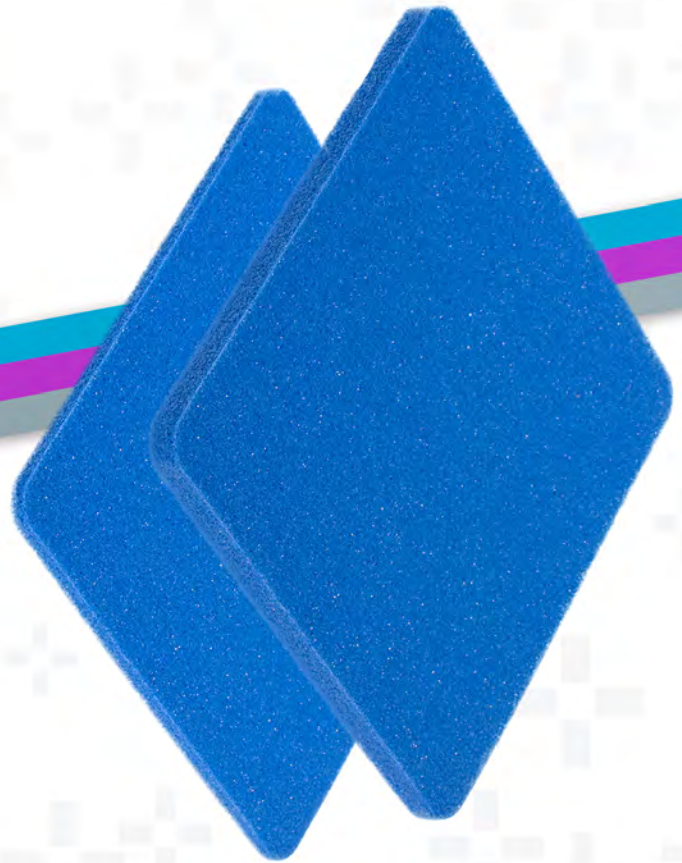

To learn more about DermaBlue™+ Foam, or to
order a sample:

Contact your DermaRite Sales Rep

Email info@dermarite.com

Call 800-337-6296

Explore DermaRite's complete catalog of skin
care, wound care, and nutritional products online
at

dermarite.com

DermaRite®